

GRILLE ELEVATION

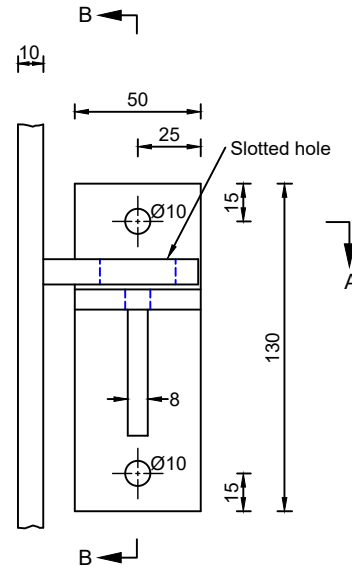

LOCK DETAIL

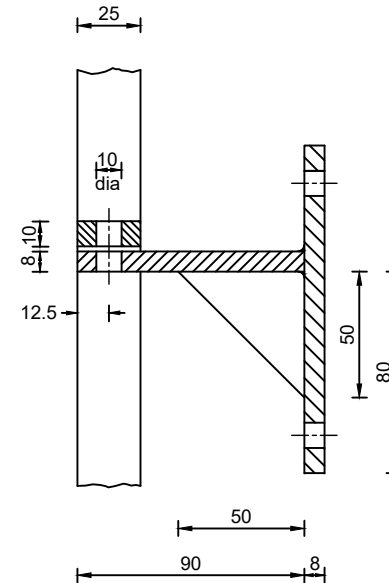

SECTION B-B

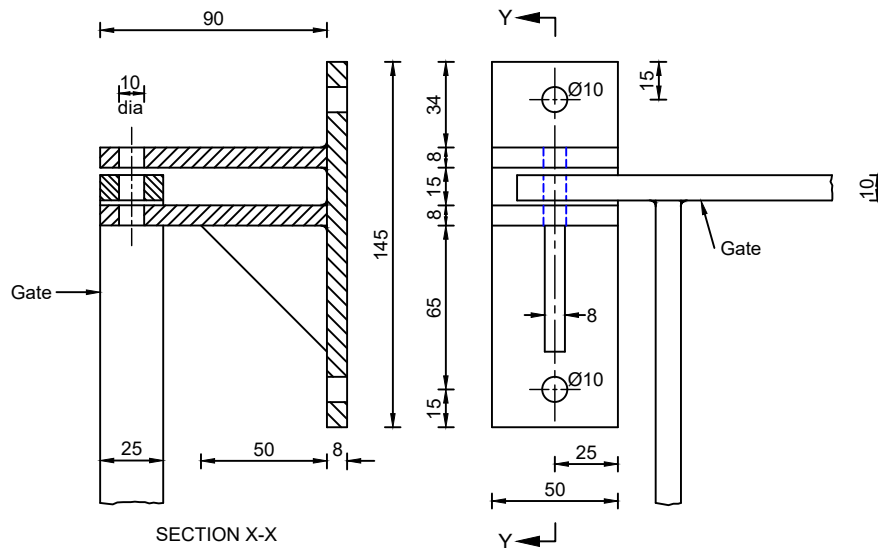

SECTION X-X

HINGE DETAIL

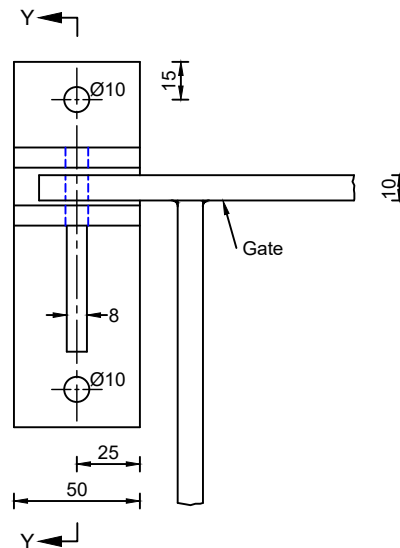

LOCKING PLATE DETAIL

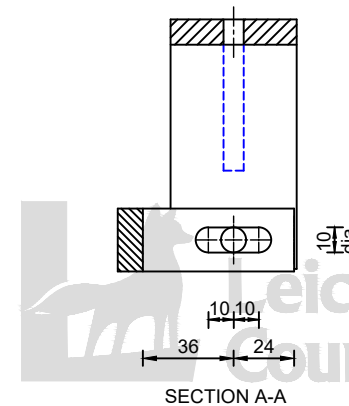

SECTION A-A

NOTES:

1. All dimensions are in millimetres unless otherwise stated.
2. All steelwork to be galvanised in accordance with BS EN ISO 1461 at 0.628kg zinc per sq m.
3. 6mm continuous fillet welds at all connections.
4. 3 no 8mm diameter stainless steel bolts to be used at hinges and locking plate and held with 'nylock' type hexagonal nuts.
5. Grille to be fixed to headwall using 6 no. M8 expanding loose bolts, zinc plated (rawlbolt type).
6. Grille is to be fixed centrally over pipe.
7. The grille shown can be used for pipe diameters of 450mm to 675mm. For larger pipes the grille size can be increased with additional 16mm diameter vertical bars as per the table below:-

PIPE DIA mm	GRILLE SIZE mm	NUMBER OF VERTICAL BARS
450 - 675	758 x 758	4
750 - 825	908 x 908	5
900 - 975	1058 x 1058	6
1050 - 1125	1208 x 1208	7

©Crown copyright 2015. All rights reserved. Use of this image is limited to viewing on-line and printing one copy. Leicestershire County Council. 100019271.



ENVIRONMENT AND
TRANSPORT DEPARTMENT

TITLE:

DRAINAGE

DETAIL OF HEADWALL GRILLE

DRAWING NUMBER

SD/500/30

DATE

APRIL 2024

AUTOCAD REF

K:\GENERAL\ID9997\STDORG\STD DRGS 2015

SCALE

NOT TO SCALE

0

01.04.2024

Supersedes Dwg. SD/5/30 - September 2002

Rev Date Notes on Revision